

FORM NO. 1.

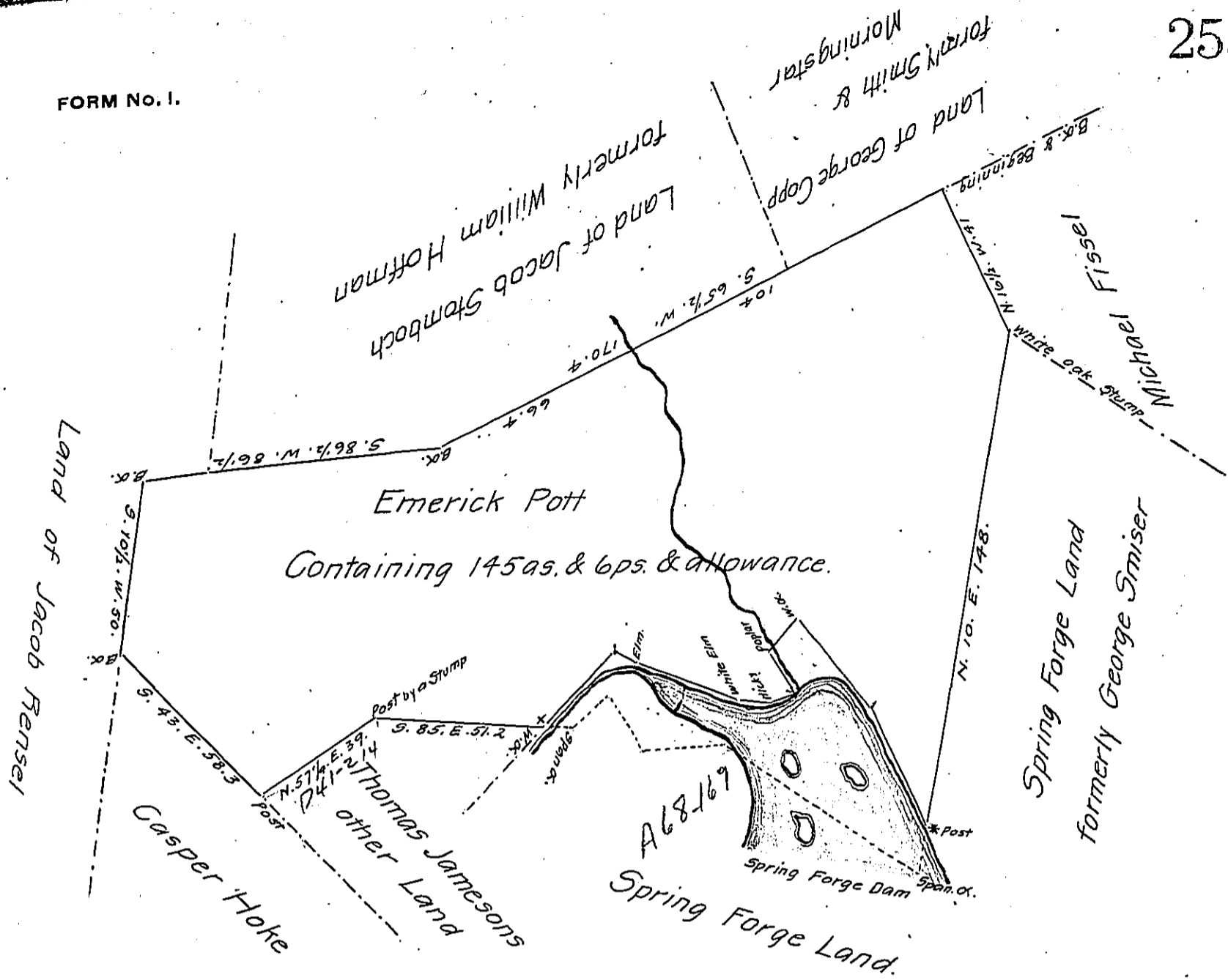

The following are the Courses and distances along down the Spring Forge Dam from + Mark^d w.o.

- N. 44. E. 29 -
- S. 62 1/2. E. 7 Elm
- S. 69 1/2. E. 39 White Elm
- S. 81 3/4. E. 10 Hickory
- N. 73. E. 7 -
- N. 32. W. 14 poplar
- N. 43. E. 12 1/2 w.o.
- S. 40 1/4 E. 33 -
- S. 24 1/2. E. 40 to * Marked Post

Situate in Paradise Township in the County of York Containing as above set forth 145as. & 6perches and Allowance Being part of a Larger tract of 152as. and allowance of Land which was Originally Surveyed by Thos. Armor D.S. Under George Stevenson late D.S. on the 16th day of October 1755 In Pursuance of a Warrant for 100as. Granted to Emerick Pott bearing date the 1st day of August 1744 And now Resurveyed and divided off from the Said Larger tract of Land on the 26th day of February A.D. 1813 at the request of Dr. Thomas Jameson who desired the Same to be Returned for Confirmation.

To Andrew Porter Esquire } per
 Surveyor General } Jacob Spangler D.S.
 Harrisburg Pa. }

IN TESTIMONY that the above is a copy of the original remaining on file in the Department of Internal Affairs of Pennsylvania, made conformably to an Act of Assembly approved the 16th day of February, 1833, I have hereunto set my Hand and caused the Seal of said Department to be affixed at Harrisburg, this twelfth day of June 1906

Lauchlin Currier
 Secretary of Internal Affairs.